

Date	Rev. date	Work nr.	Drw. nr.	Rev.
Drawn by Ruukki	Rev.	N29/S22	-	
Scale 1:2	Building		File nr. P2021/001-00035	

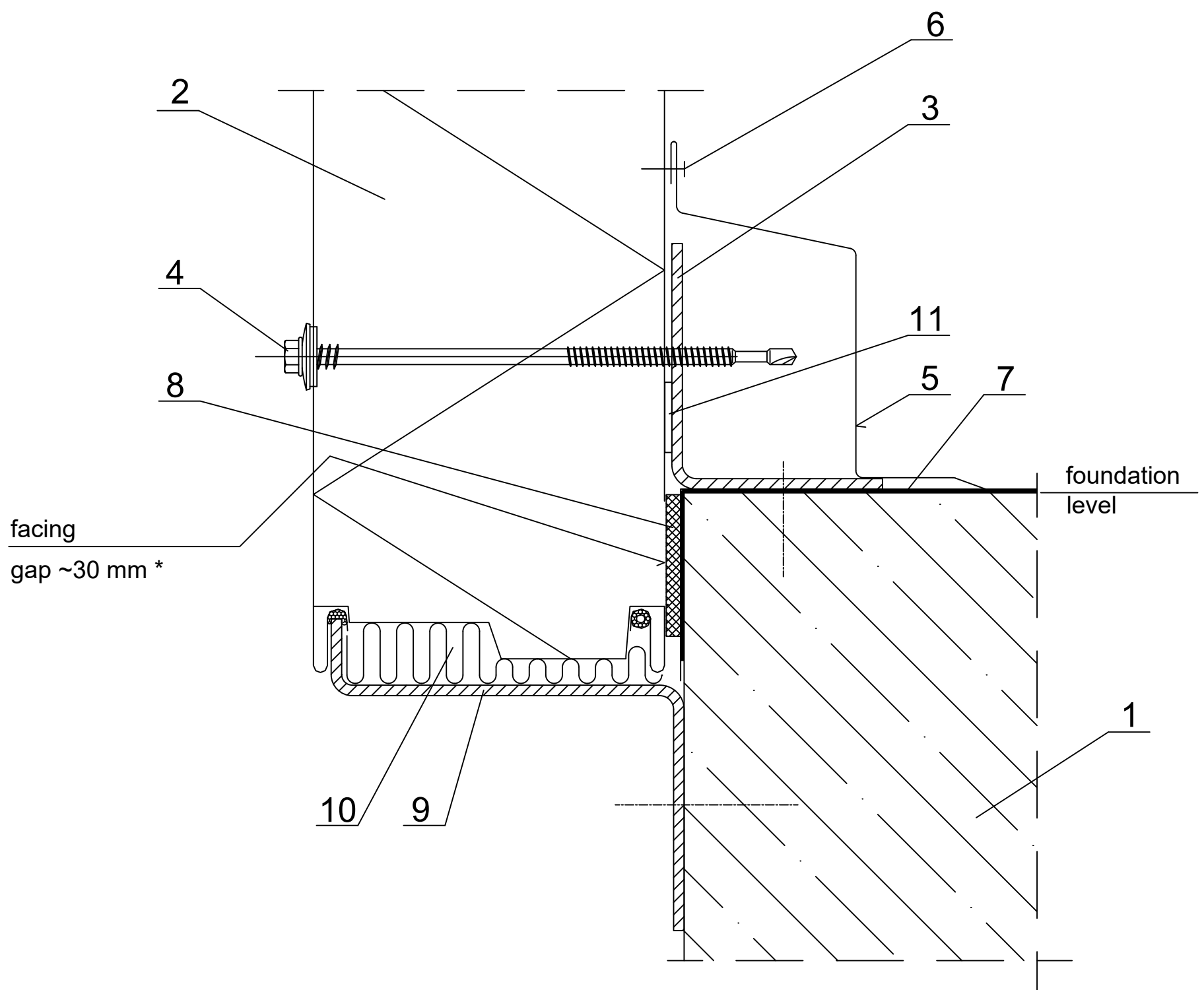

1. Ground beam acc. to engineering design of the structure
2. Ruukki nSPB W / nSPB WS / nSPB WE / nSPB WF / nSPB WEE.
3. Socle sheeting rail acc. to engineering design of the structure
4. Panel fastener for hot-rolled sheeting rail or for cold-bent sheeting rail.
5. EA1B02 plinth flashing.
6. Steel rivet (every 300 mm).
7. Horizontal insulation acc. to architectual design of the structure
8. 8x40 PU self-adhesive sealant.
9. Socle beam acc. to engineering design of the structure.
10. Loose mineral wool.
11. 4x20 PIR self-adhesive sealant.

* for structures with high requirements regarding thermal insulation facing gap is ~30 mm;